

## 18 Perry Street Mudgee NSW

Large two-story commercial premises suitable for studio, offices or retail use.

- Ground floor separated by two areas of approx. 110m<sup>2</sup> each
- Front entry plus level side and rear access
- Parking at rear with separate entrance off Mortimer Street

Don't miss this unique opportunity!

**Price** : \$41600 pa  
**Building Size** : 500 sqm  
**View** : <https://www.thepropertyshop.com.au/lease/nsw/dubbo-orana/mudgee/commercial/retail/7924580>



**Anthony McCarney**  
02 6372 2222



**June Lewis**  
02 6372 2222

**Perry Hall 18 Perry Street**

**Ground Floor**

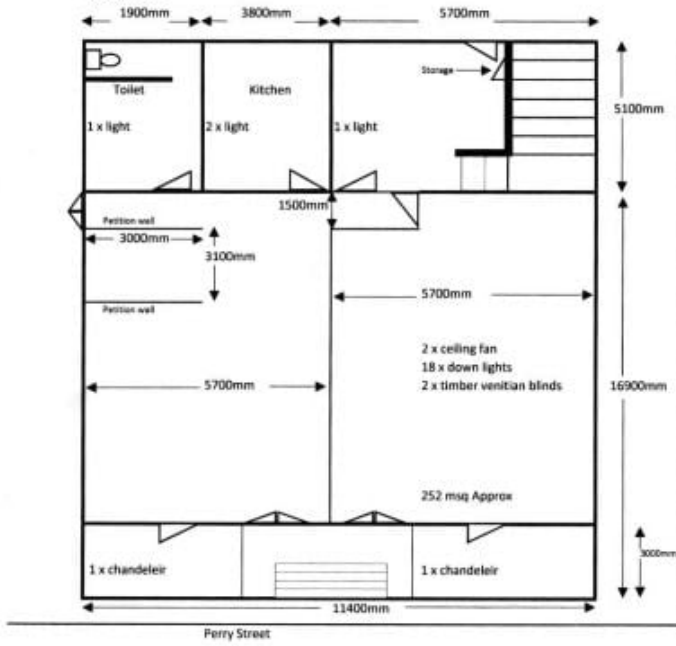

All dimensions are approximate and not to scale



**First Floor**

