



228 Buckaroo Road Mudgee NSW

4 🏠 2 🚗 4 🚗

This extraordinary property provides a unique opportunity to own a country cottage with ample space for personalization. 'THE RANCH' is conveniently located just 8 minutes from the heart of Mudgee's CBD, nestled on 8.8 hectares or approximately 22 acres of cleared grazing country. It presents an exceptional prospect for those aspiring to embrace a rural lifestyle.

- Main houses consist of two spacious bedrooms plus optional study
- Offering multiple living areas ideal for the growing family
- Recently updated kitchen with electric cooking and loads of storage
- Attached Granny flat with two bedrooms, one bathroom, kitchenette and living room
- Offering 2 main dams and approx.50,000L rainwater storage
- Shedding consists of a 3 bay machinery shed, 3mx2m shed plus workshop and garden shed
- Stunning 8.89ha of countryside, fully fenced and offering 6 main paddocks
- Suitable for cattle, sheep, cropping and horses or anything the heart desires

Price : GUIDE \$850,000
Land Size : 8.89 ha
View : <https://www.thepropertyshop.com.au/sale/nsw/dubbo-orana/mudgee/residential/rural/7854379>



David Goldring
02 6372 2222



Jessika Weatherall
02 6372 2222

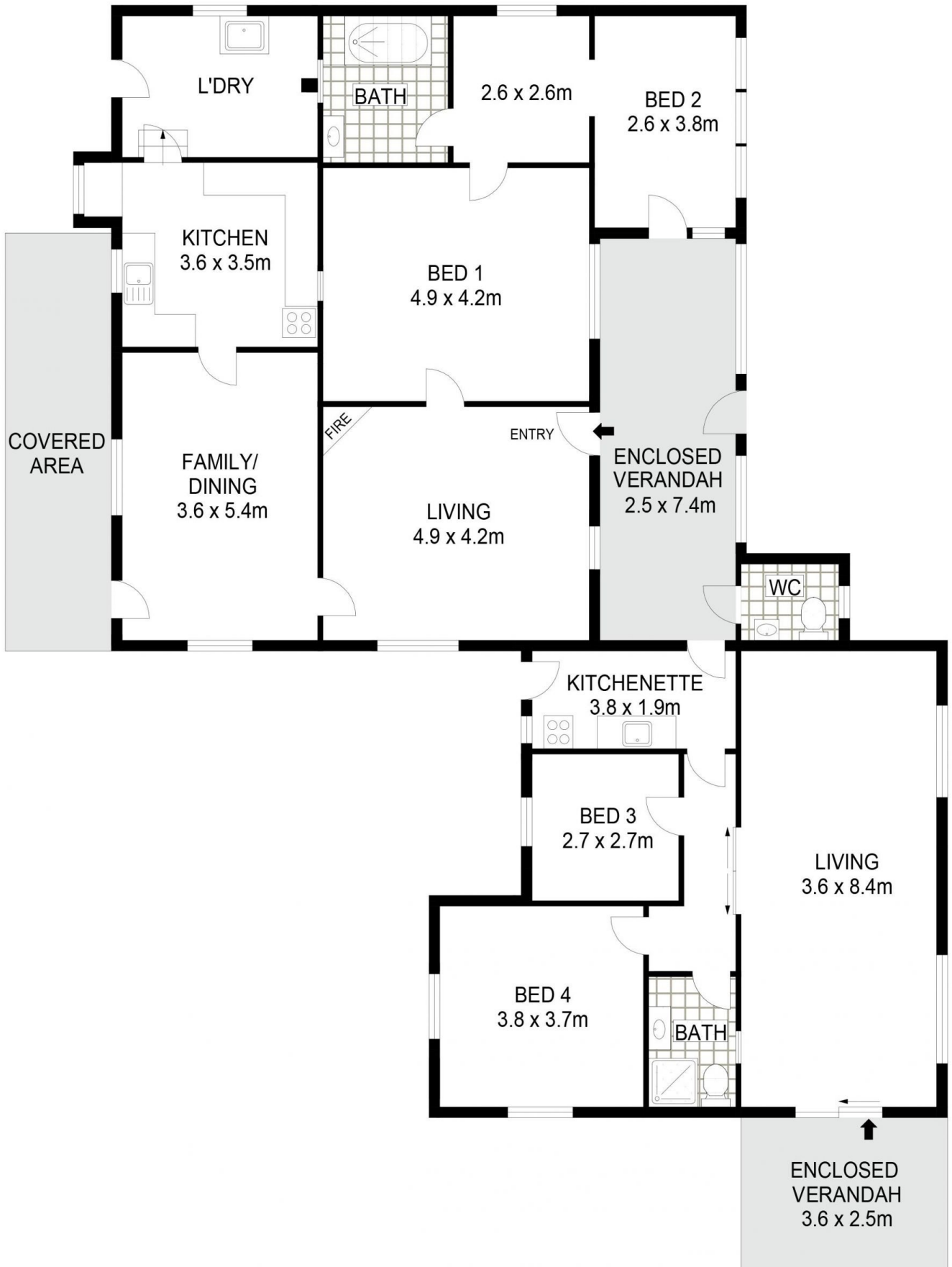

228 BUCKAROO ROAD

BUCKAROO



Floor plans and rooms sizes are indicative only

