



**10 Avisford Court Mudgee NSW**

5 🏠 4 🚗 8 🚗

Boasting a serene rural panorama from its elevated location in Mudgee's most prestigious residential district, this exquisite residence offers a lifestyle of sophistication, prime positioning, and opulent spaciousness.

This masterpiece redefines luxury, setting an ultra-stylish benchmark for design and construction with superb craftsmanship, showcasing a calming palette of natural materials and everlasting finishes. Revel in the abundance of natural light with expansive views along with a fully self-contained granny flat, resembling that of a 5 Star Bali Villa with its own entrance; ideal for the in-laws, guests or an added boost of a lucrative income from the short-term rental market.

- An entertainers' home set on 4463m2 of established lawns, hedges and blossoming gardens which provide privacy and tranquillity
- Million dollar sweeping views, across the valley and beyond
- Gourmet designer kitchen: 80mm stone benchtops complete with an inbuilt coffee machine, walk-in pantry, and an impressive mood-lit bar area that opens onto the

**Price** : CONTACT AGENT  
**Land Size** : 4463 sqm  
**View** : <https://www.thepropertyshop.com.au/sale/nsw/dubbo-orana/mudgee/residential/house/7790774>



**Andrew Palmer**  
02 6372 2222



**Alyse Pilley**  
02 6372 2222

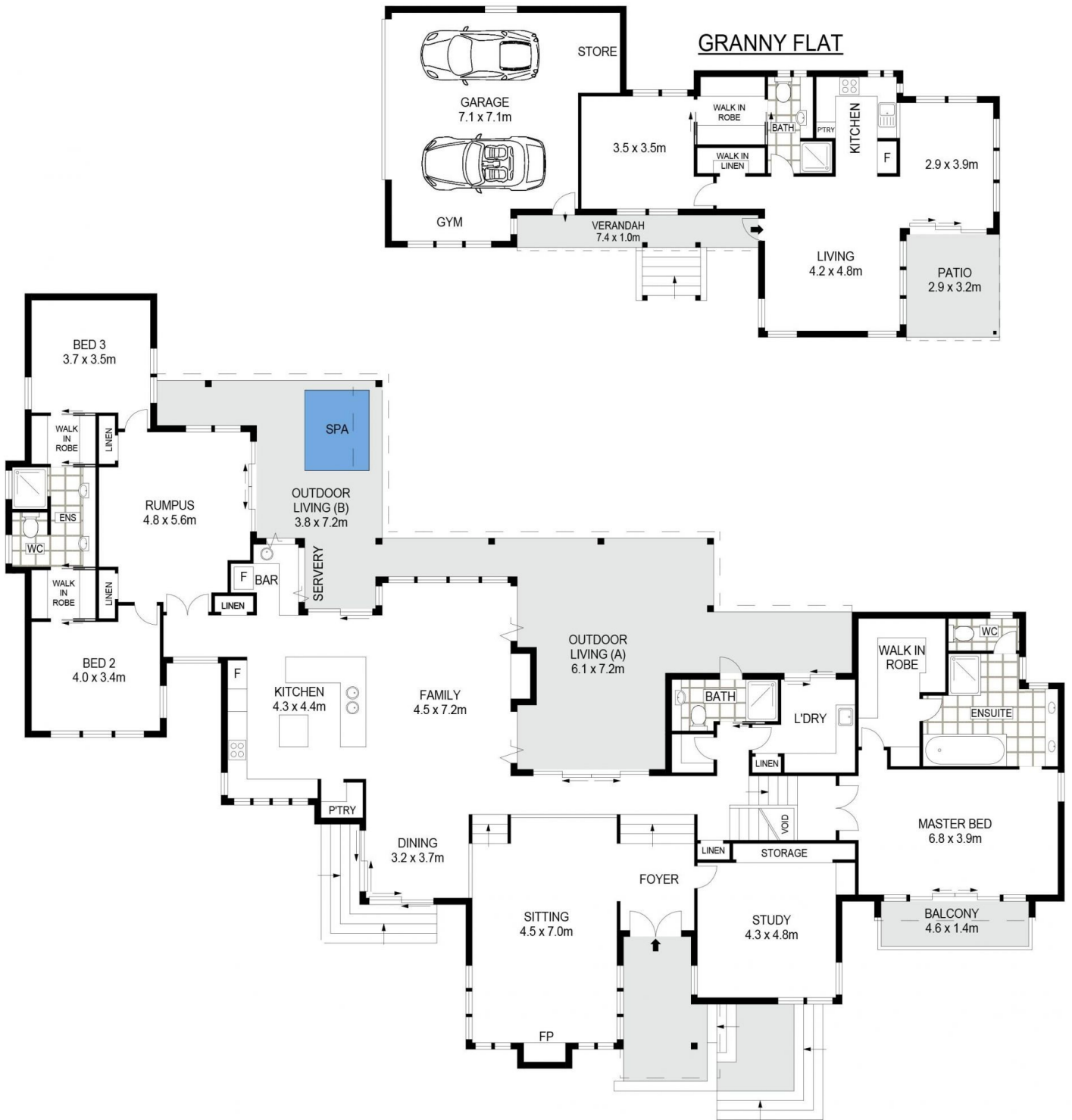

SITE PLAN (NOT TO SCALE)



10 AVISFORD COURT

MUDGEE



Floor plans and rooms sizes are indicative only

PALERMO ROAD



AVISFORD COURT



10 AVISFORD COURT

MUDGEES



Floor plans and rooms sizes are indicative only