



18 Steel Drive Mudgee NSW

4 🛏 2 🚗 3 🚗

A haven of space and light, this stylish floorplan embraces four spacious bedroom and relaxed living areas both indoors and out. Positioned in a family friendly cul-de-sac offering a desirable lifestyle of comfort and easy family living this is the perfect family home

View : <https://www.thepropertyshop.com.au/lease/nsw/dubbo-orana/mudgee/residential/house/7599692>

- Four spacious bedrooms all with built in robes
- Main bedroom featuring grandeur ensuite featuring a free-standing bath and walk-in wardrobe
- Open plan living and dining area with raked ceilings
- Lavish kitchen with superior SMEG appliances and butler's pantry
- Formal lounge room or media room perfect for the entire family to enjoy
- Triple garage with internal access



Ashlee Parker
0435 039 435



Karen Denyer
6372 2222

- Electricity and Water are the responsibility of the tenant
- This property is NOT furnished

FLOOR AREAS

LIVING	235 m ²
ALFRESCO	25 m ²
GARAGE	60 m ²
PORCH	12 m ²
TOTAL	334 m²

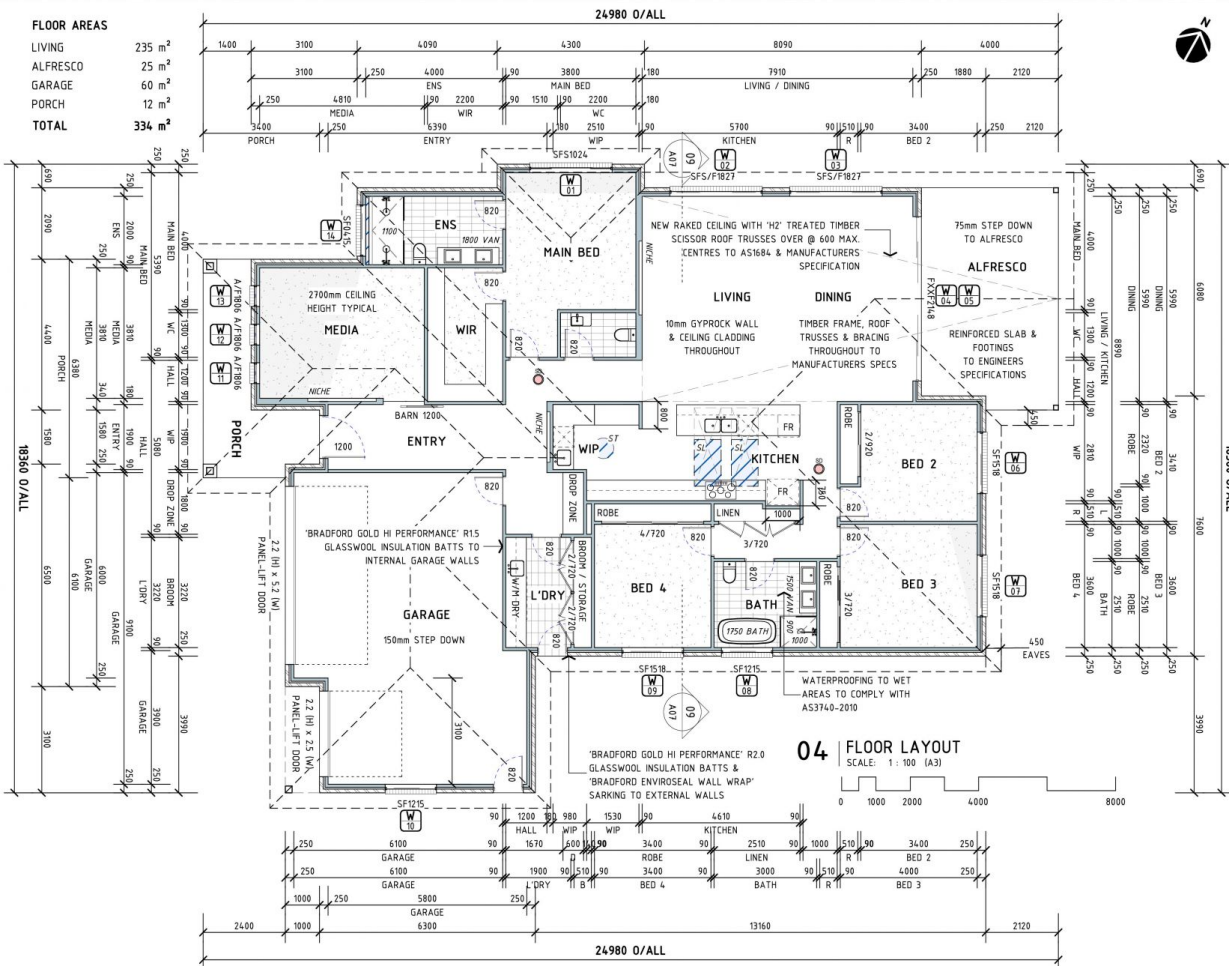

CONTACT DETAILS

Catherine Hackett
M. 0437 752 740
E. getwell@onpointbuildingdesign.com.au
A. 17 Church Street, Mudgee NSW 2850

THIS DRAWING IS AND ALWAYS SHALL REMAIN THE PROPERTY OF ON POINT BUILDING DESIGN AND MUST NOT BE REPRODUCED OR TRANSMITTED IN ANY FORM OR BY ANY MEANS, WITHOUT THE WRITTEN CONSENT OF ON POINT BUILDING DESIGN. ALL DIMENSIONS ARE IN MILLIMETRES UNLESS OTHERWISE SPECIFIED. DIMENSIONS TO BE CHECKED ON SITE BEFORE COMMENCEMENT OF WORK.

Client:
HAYES CONSTRUCTION COMPANY
PROPOSED RESIDENCE AT
18 STEEL DRIVE,
SPRING FLAT

Drawing Title:
FLOOR PLAN

Rev	Date	Amendment
A	22/03/22	PRELIMINARY DRAWINGS
B	24/03/22	PRELIMINARY DRAWINGS
C	5/04/22	ISSUED FOR APPROVAL



Job Number: 1311 - A04
Revision: C
Sheet: 04 of 09

ISSUED FOR APPROVAL