



13 Lovejoy Street Mudgee NSW

4 3 6

"Glen Isla" was built c1915 For Thomas Lovejoy, the then Town Clerk and designed by well known Mudgee Architect Harold Hardwick (1866 - 1935) who also designed 'Lauralla', 'Forgandenny' Rexton and many others.

Land Size : 1557 sqm
View : <https://www.thepropertyshop.com.au/lease/nsw/dubbo-orana/mudgee/residential/house/5659316>

"Glen Isla" of brick construction with slate roof stands on a 1557sqm approx. landscaped private block with access through to Mortimer Street.

Featuring ornate 12ft ceilings in some rooms, the home has 4 bedrooms 2 with ensuites, main bathroom dining and lounge rooms, east facing sunroom, study, kitchen with Smeg appliances and Spinsters Gallery.

There is a huge Mudgee slate flooring recreational room with inground pool, spa and kitchen facility. The owners are even including a full size billiard table in this room.

Plenty of comforts as well with ducted reverse cycle air conditioning.

An excellent locale just metres from Mudgee's shopping centre.

<https://www.thepropertyshop.com.au>

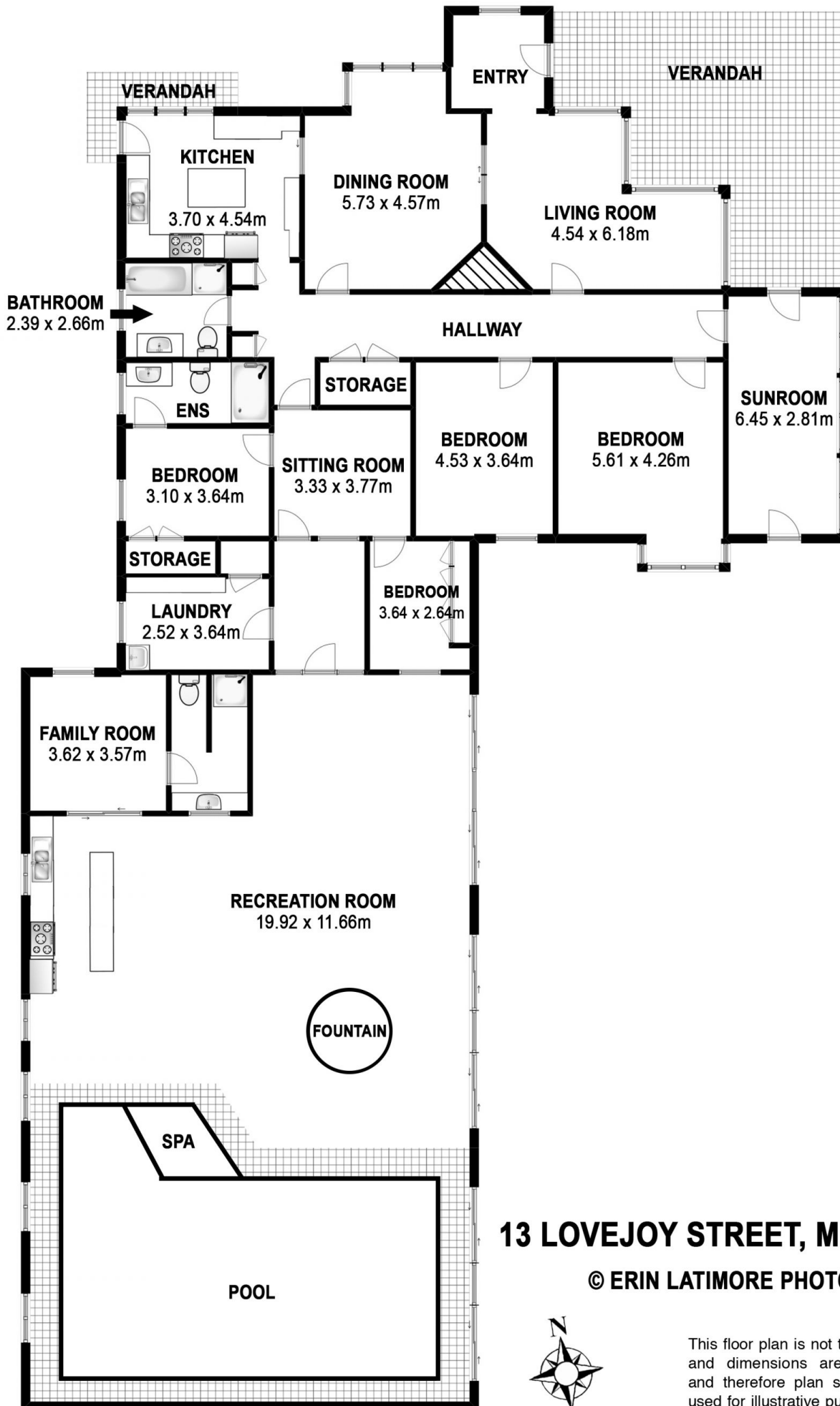

13 LOVEJOY STREET, MUDGEE

© ERIN LATIMORE PHOTOGRAPHY



This floor plan is not to scale. Areas and dimensions are approximate and therefore plan should only be used for illustrative purposes.