

1 Inglis Street Mudgee NSW

Near new building with modern office facilities and amenities. Close to the CBD approximately 775m² and a further 90m² under cover. Currently divided into 2 spaces. Fully fence yard.

10 

Building Size : 775 sqm
View : <https://www.thepropertyshop.com.au/lease/nsw/dubbo-orana/mudgee/commercial/industrial/5659246>



June Lewis
02 6372 2222

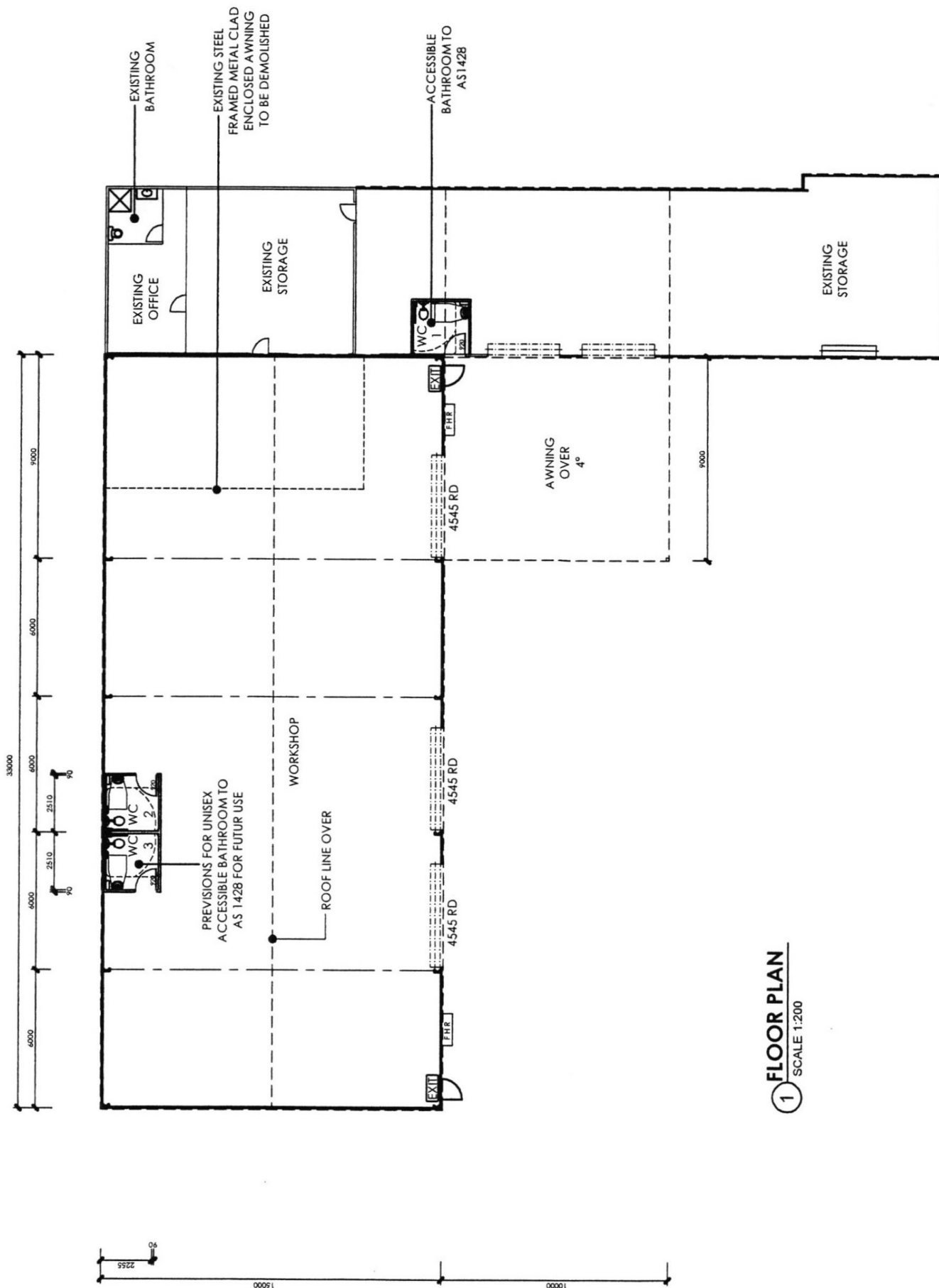

1 FLOOR PLAN
SCALE 1:200