



6/5 Depot Road Mudgee NSW

Huge industrial Unit located in Depot Road, 282m² of open plan warehouse floor space with easy access via 2 x 5m x 5.5m roller doors and personal access door, 3 phase power and high bay lighting.

Building Size : 282 sqm
View : <https://www.thepropertyshop.com.au/lease/nsw/dubbo-orana/mudgee/commercial/industrial/5658947>



June Lewis
02 6372 2222

ROLLER DOOR RAISE 1005.5"
3x 2 PHASE POWER PTS
4x HI BAY LIGHTS

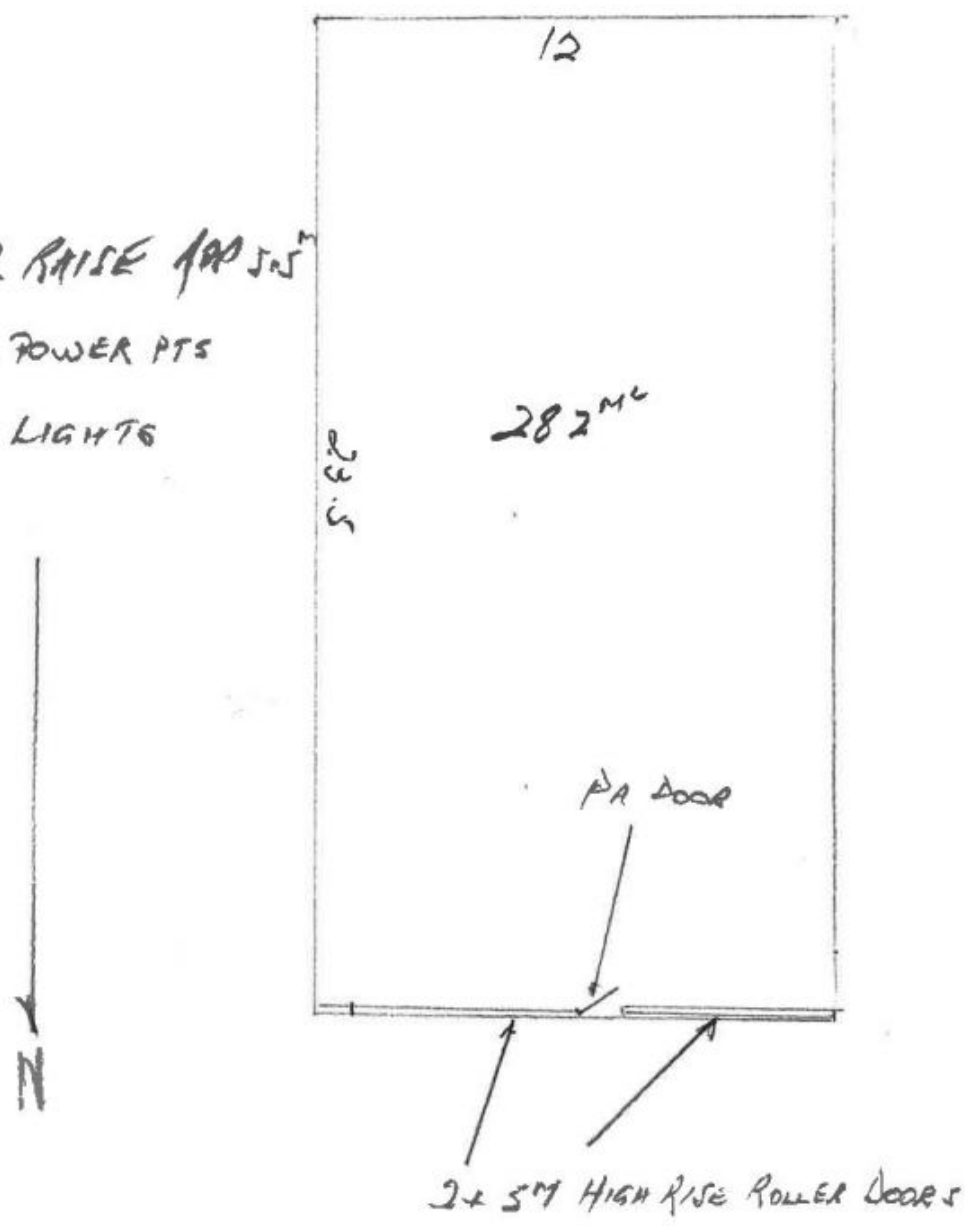

UNIT 6 - 5 DEPOT ROAD