



10 Swords Court Mudgee NSW

Industrial unit in Swords Court with wide high opening roller door, kitchenette and toilet facilities and back to base alarm.

3 phase power connected.

There is also ample access for loading and unloading of goods.

Approximately 100m²

Building Size : 100 sqm

View : <https://www.thepropertyshop.com.au/lease/nsw/dubbo-orana/mudgee/commercial/industrial/5658746>



June Lewis
02 6372 2222

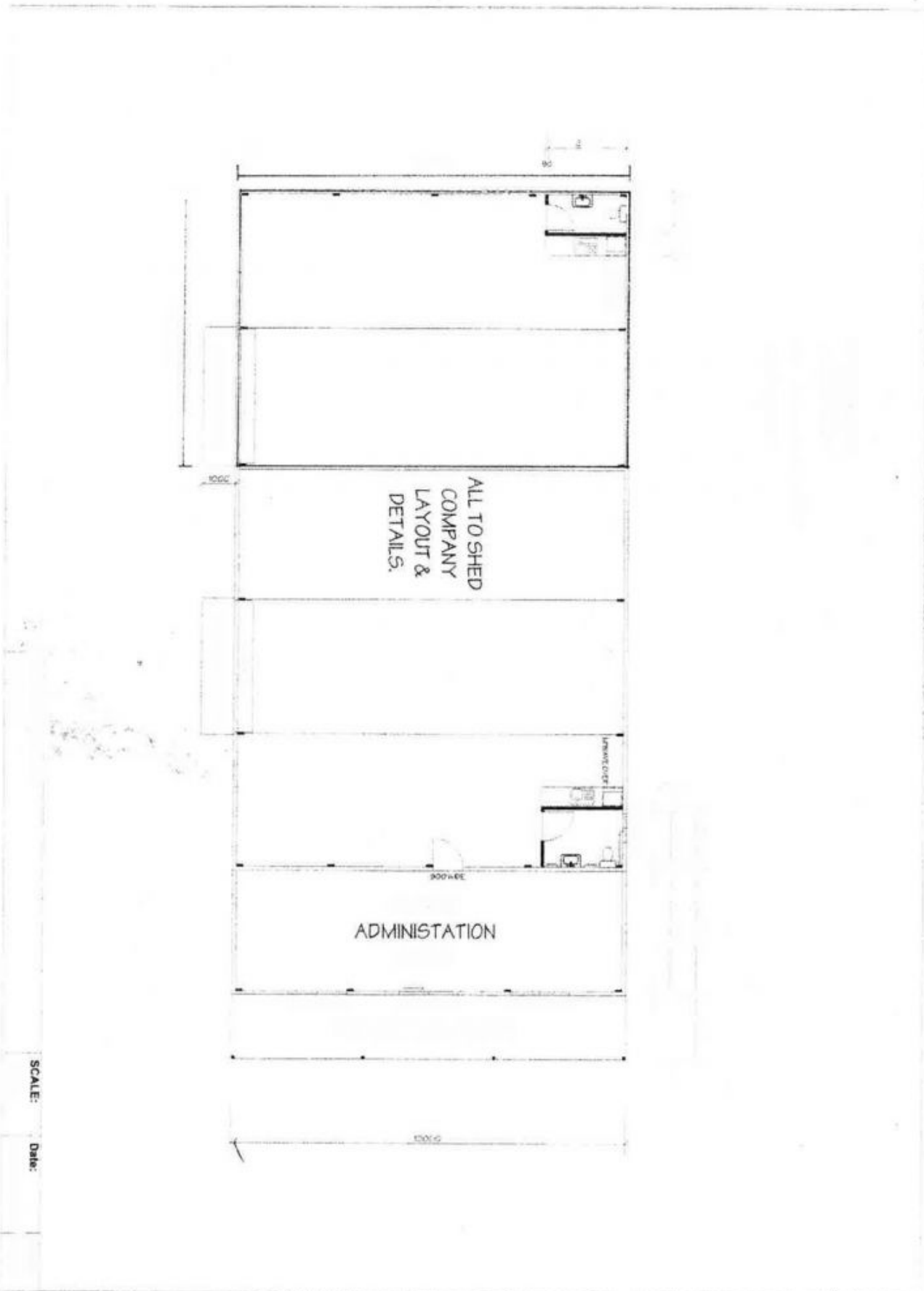

SCALE:

Date: